

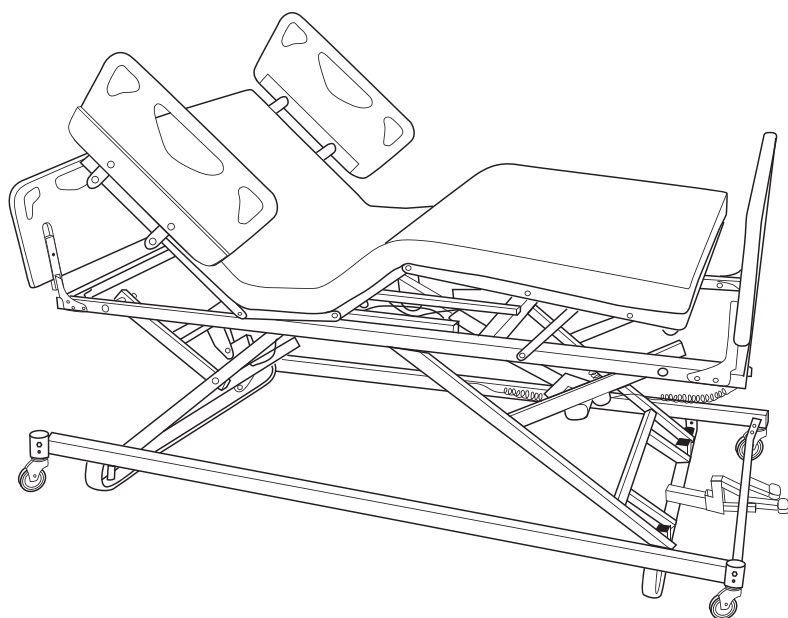

CENTURY LTC BED T8036 and T8042 OPERATION MANUAL



ATTENTION

Before using this Medical Device read this manual. If you are unable to understand, contact your equipment provider for technical support before attempting to use this bed.

TABLE OF CONTENTS

3 Product Specifications T8036/T8042

4 Product Diagram

SECTION 1 - General Guidelines

6 General Guidelines

8 Assembly Precautions

SECTION 2 - Assembly

8 Assembling the Head Section Motor on the Main Frame

10 Assembling Swing-down Half Bed Side Rails (Optional)

11 Assembling the Mattress - Stop on the Foot End of Main Frame

11 Preparing the Bed for Use

SECTION 3 - Operation

12 Locking/Unlocking the Casters

13 Raising/ Lowering the Bed

14 Pendant Functions

14 Hi-Low Control Panel Functions

15 Junction Box Functions

16 Raising/Lowering the Bed Side Rails

SECTION 4 - Maintenance

17 Cleaning the Bed

17 Detecting Wear and Damage

17 Lubricating the Bed

SECTION 5 - Warranty

19 Limited Warranty

PRODUCT SPECIFICATION

T8036 / T8042 CENTURY LONG TERM CARE BEDS

Control Operation: Dual DC Motors System with 5 Function Pendant

Bed Fabric Height: 9.75 - 31 inches

Sleep Surface: T8036 – 36x80 inches, T8042 – 42x80 inches

Overall Length: 86.50 inches

Overall Width: T8036 – 36 inches, T8042 – 42 inches

Overall Height (with Side Rail Up): 47 inches

Maximum Back Angle to Horizontal: 65 degrees

Maximum Knee Angle to Horizontal: 43 degrees

Maximum Knee to Leg Angle: 120 degrees

Casters: 4x 4" Swivel Casters with Central Braking System

Rail Height (from Fabric): 16.50 inches

Board Height (from Fabric): 15 inches

Weight Capacity: 600 lbs

Weight: T8036 - 205 lbs, T8042 – 232 lbs

Emergency Backup Battery: Yes

Limited Warranty bed/Electronics: 3 Years/1 Year

PRODUCT DIAGRAM

T8036 – 36x80" Standard Bed / T8042 – 42x80" HD Bed

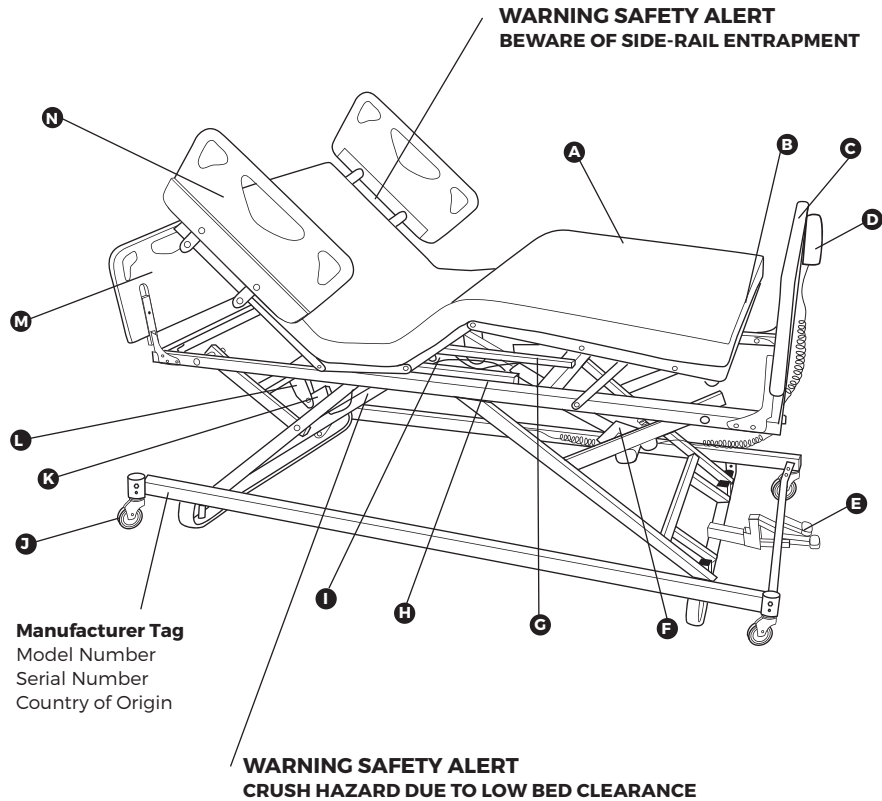

WARNING SAFETY ALERT **BEWARE OF SIDE-RAIL ENTRAPMENT**

Patient Entrapment with bed side rails may result in serious injury or death. ALWAYS evaluate patient for and guard against bed rail entrapment in accordance with medical protocols. Monitor patient frequently. Mattress MUST fit bed frame and side rails snugly to prevent entrapment. There may be an increased risk of entrapment when bed rails are used in conjunction with low air loss products. Follow the Safety Warnings and Operating Instructions in the service/User's manual. Contact your dealer or www.tuffcare.com.

WARNING Crush Hazard due to LOW BED CLEARANCE. Stay clear of frame and ensure children and pets are not under or near the frame before lowering the bed. Beware of PINCH POINTS below deck panels, next to fixed attachments and between moving parts.

- | | |
|-----------------------------|---|
| A Foam Mattress | H Main Frame |
| B Mattress Stop | I Head Section Motor |
| C Footboard | J Caster with Lock |
| D Hand Pendant | K Junction With Rechargeable Battery |
| E Locking System | L Hi-Low Motor |
| F Hi-Low Motor | M Headboard |
| G Foot Section Motor | N Half Bedside Rails |

SECTION 1

GENERAL GUIDELINES

GENERAL GUIDELINES contains important information for the safe operation and use of this Medical Device.

WARNING



DO NOT operate your institutional bed until you have read and fully understand this Manual and **DO NOT** operate your institutional bed until it is fully assembled and checked.



STAND CLEAR OF DEVICE FRAME

Operating this device with any part of the body in the frame can result in injury. **DO NOT** place arm or head into the frame while operating. Stand clear of device frame before operating.



KEEP CLEAR OF ROTATING AND MOVING PARTS

Keep fingers and arms away when mechanism is moving. **DO NOT** leave loose clothing or self in between moving parts.



KEEP CLEAR OF PINCH POINT

Keep fingers and arms away when bed is in movement. Pinch points exist at base of lifter. **USE CAUTION**, otherwise injury could occur.



AVOID ELECTRICAL HAZARDS

Electrical hazard may occur if device is plugged into an inadequate electrical outlet. To avoid electrical shock hazard, make sure the bed is plugged into a grounded 110 Volt outlet. The power supply cord can only be replaced by service personnel.

DO NOT use if power cord is cut, frayed or loosely connected to the device. DO NOT EXPOSE electrical components to any highly flammable items. Power cord may be damaged by inappropriate handling, kinking, shearing or other mechanical damages.

To avoid risk of electric shock, this equipment must only be connected to supply mains with protective earth. Do not to position the bed to make it difficult to disconnect from supply mains with protective earth.



INDOOR USE ONLY

DO NOT expose your institutional bed to weather or moisture.



USE THE CORRECT MATTRESS

DO NOT use your institutional bed with the improper mattress.



DO NOT EXCEED WEIGHT LIMIT

DO NOT exceed maximum weight limit of the bed. The weight limit for the bed is 450 lbs for T8036, 600 lbs for T8042.



DO NOT MODIFY THE EQUIPMENT

DO NOT modify this equipment without authorization of the manufacturer. After reading the instruction, it should be put in a place where it can be seen at any moment.

ASSEMBLING PRECAUTIONS



Pre-assembled one piece grid design frame with fully loaded electronics system requires minimum set up.



DO NOT over-tighten mounting hardware. It will cause a damage of mounting brackets.



Be sure that bed side rails are properly attached on main frame before the patient is moved into the bed.



Secure the caster locks in place to prevent the bed moving.



The medical bed should be left in its lowest position when the patient is unattended in order to reduce RISK of injury due to falls.

SECTION 2

ASSEMBLY

Pre-assembled one piece grid design frame with fully loaded electronics system, not assembling requires for main frame.



WARNING

Use only Tuffcare parts to complete this bed assembly.

ASSEMBLING THE HEAD/FOOT BOARD ON THE MAIN FRAME

Note: Check Head Board (Size: 36" or 42"x15"), Foot Board (Size:36" or 42" x15") and hardware before installation.

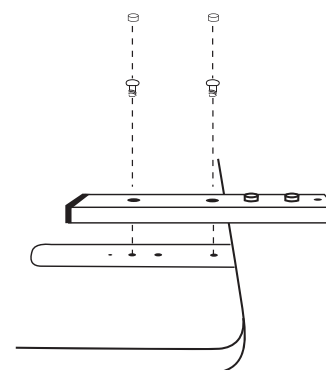
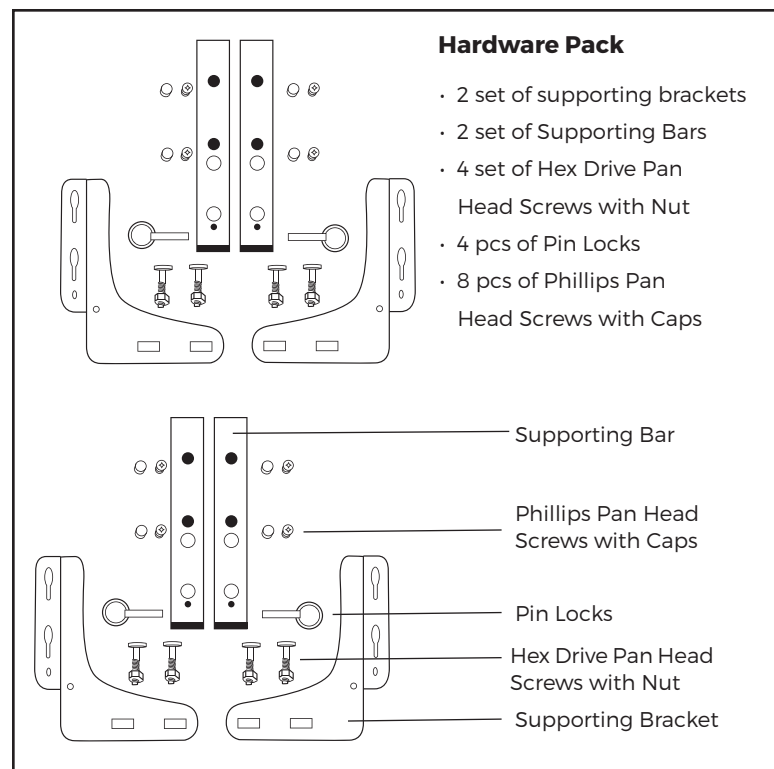

- 1 Install Head & Foot Board, using 2 pcs of Phillips Pan Head Screws to secure the Head/Foot board on supporting bar and use cap to cover the screw then repeat the other side.

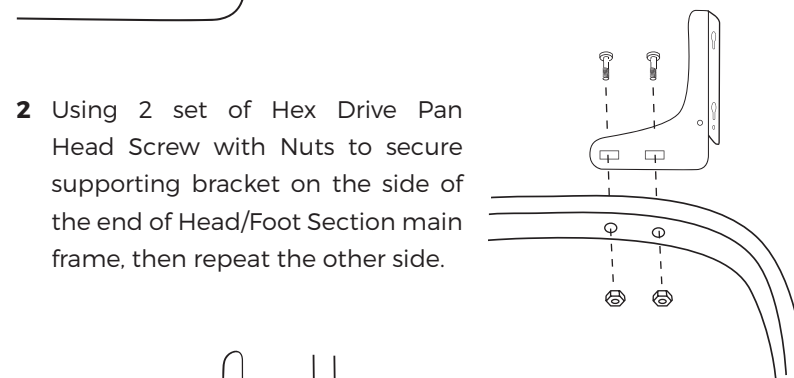

- 2 Using 2 set of Hex Drive Pan Head Screw with Nuts to secure supporting bracket on the side of the end of Head/Foot Section main frame, then repeat the other side.

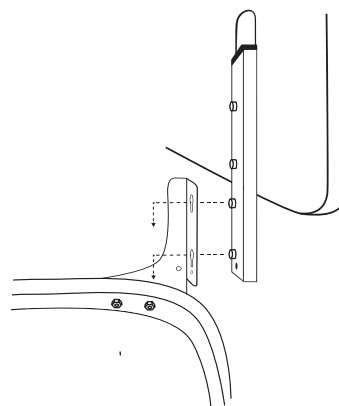

- 3 Use both hands to position Head/Foot board. Align the supporting bar screw into the holes of bracket then slide head/foot board down.

- 4 Secure the pin lock into the lower hole on the supporting bar, then repeat the other side.

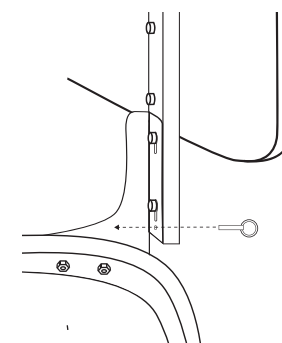

ASSEMBLING SWING-DOWN HALF BED SIDE RAILS (OPTIONAL)

Note: Secure the caster locks in place to prevent the bed moving.

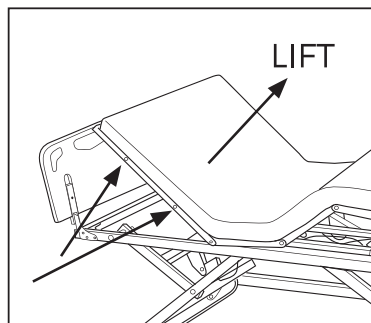

- 1** Raise the head frame to expose the holes on top of bed frame.

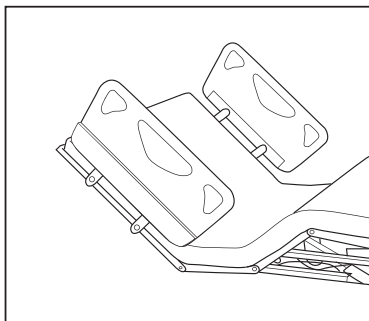

- 2** Position half bedside rails swing bars on top of bed frame.

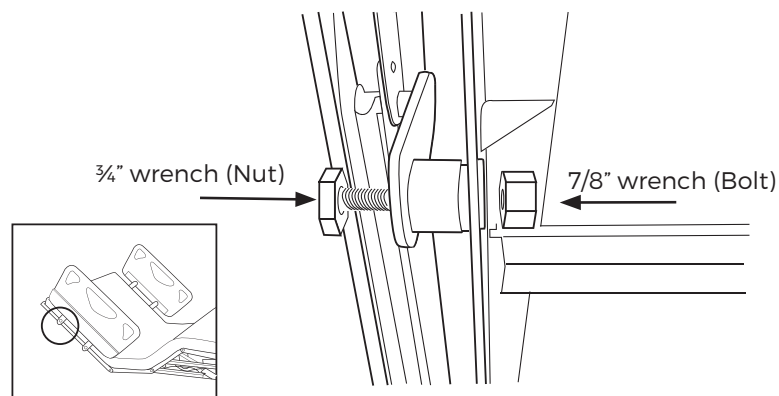

- 3** Install bolt and tighten into the holes while holding the nut with your other hand.
- 4** Use 7/8" wrench (bolt) & 3/4" wrench (Nut) to secure the swing bars on top head section frame.

- 5** Connect the 4 pin round plug into the junction box for optional bed side rail with Hi-low control panel.

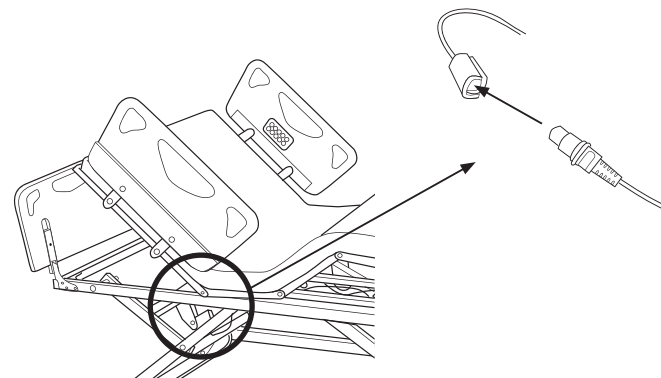

ASSEMBLING MATTRESS-STOP ON THE FOOT END OF MAIN FRAME

Note: This procedure is for T8042 HD Bed only

- 1** Install the mattress-stop into the holes located on the end of upper foot section frame.
- 2** Use bolt & nut to secure mattress stop on upper foot section frame.

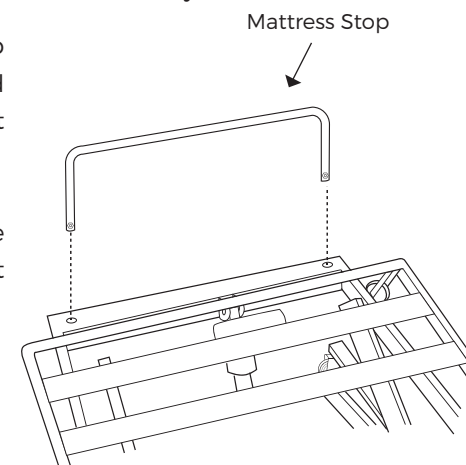

PREPARING THE BED FOR USE

- 1** Make sure all of electronic components are well connected, and all of wires are clear from moving parts.
- 2** Check and tighten all hardware BEFORE use.

SECTION 3

OPERATION

⚠ WARNING

The user must be assessed by a qualified professional. Thoroughly read and fully understand the instructions in this Owner's Manual. If you are unable to understand, contact your equipment provider for technical support before attempting to use this bed.

LOCKING/UNLOCKING THE CASTERS

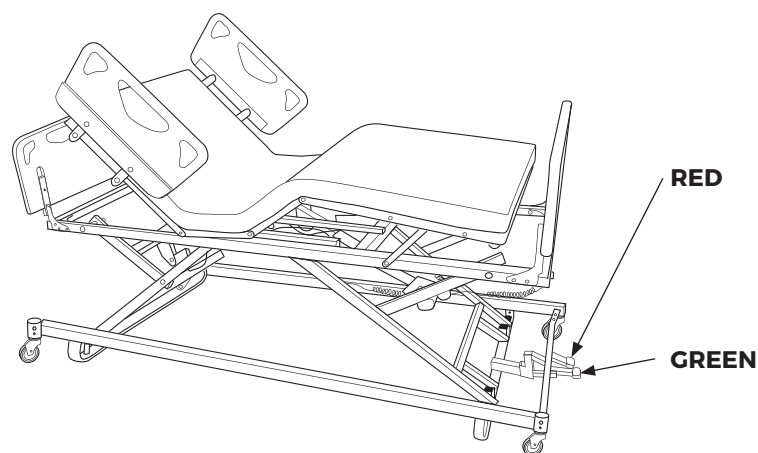

Depress the GREEN pedal to UNLOCK all four caster wheels

Depress the RED pedal to LOCK all four caster wheels

RAISING/LOWERING THE BED

- ⚠ WARNING** DO NOT exceed the maximum weight limit of Beds: T8036 – 450 lbs, T8042 – 600 lbs.
- ⚠ WARNING** Operating this device with any part of the body in the frame can result in injury. Do not place arm or head into the frame while operating.
- ⚠ WARNING** Stand clear of device frame before operating.
- ⚠ WARNING** Rotating Parts. Keep fingers and arms away when mechanism is moving.
- ⚠ WARNING** Keep fingers and arms away when bed is in movement to avoid pinching.
- ⚠ WARNING** Electrical hazard may occur if device is plugged into an inadequate electrical outlet. To avoid electrical shock hazard, make sure the bed is plugged into a grounded 110 Volt outlet. Before operating, make sure casters are in their proper operating position. Hand Controller Functions, press button indicated to move bed.

PENDANT FUNCTIONS

Press indicated buttons to move the bed up and (or) down.



- A** Head Section
- B** Foot Section
- C** Head & Foot Section
- D** Hi-Low
- E** Hi-Low Trendelenburg

HI-LOW CONTROL PANEL FUNCTIONS

Hi-low control panel Functions on bed side rail or Foot board (option), press button indicated to move bed up and (or) down

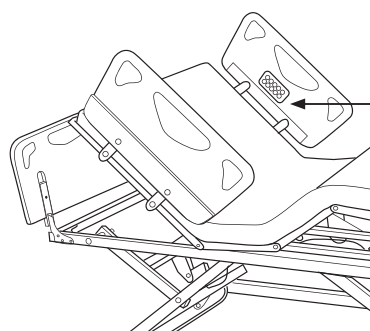

HI-LOW CONTROL PANEL

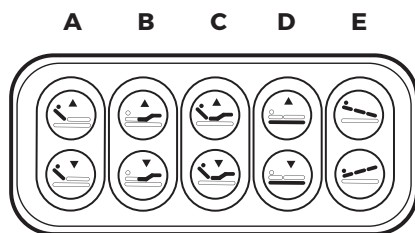

- A** Head Section
- B** Foot Section
- C** Head & Foot Section
- D** Hi-Low
- E** Hi-Low Trendelenburg

JUNCTION BOX FUNCTIONS

Control of all of electronic components.

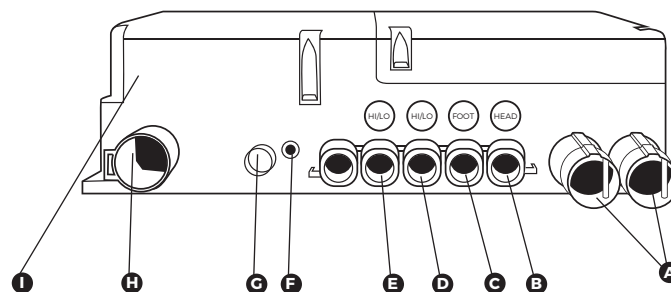

- A** Hand Pendant/Control Panel
- B** Head Motor
- C** Foot Motor
- D** Hi-Low Motor (installed on Foot Main Frame)
- E** Hi-Low Motor (installed on Head Main Frame)
- F** Battery Indicator Light (green when charged)
- G** Fuse Box
- H** Power Cord with
- I** Ground connection
- J** Built-in Backup Re-chargeable Battery

Use built-in rechargeable battery backup power for emergency operation. **Note:** The indicated light will be turned green when battery is fully charged

RAISING UP & LOWERING DOWN BEDSIDE RAILS

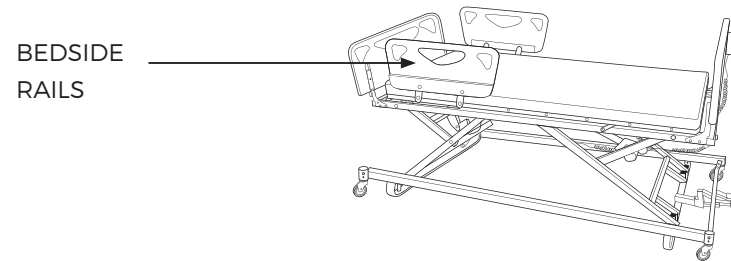

RAISING UP

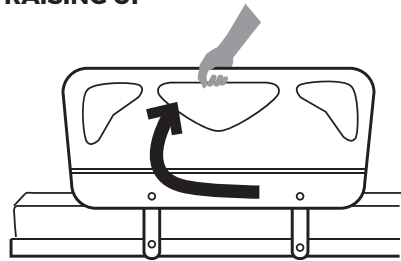

Swing up bed side rail to the upper position, then slide push down to ensure the lock is engaged.

Note: There is only one upper locking position for Tuffcare bed side rails.

LOWERING DOWN

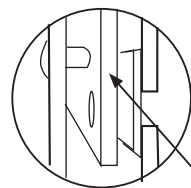
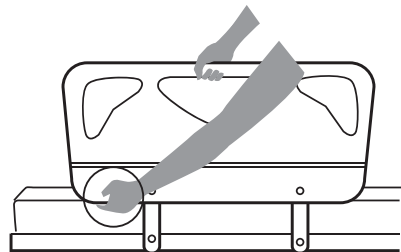

Press Release Trigger

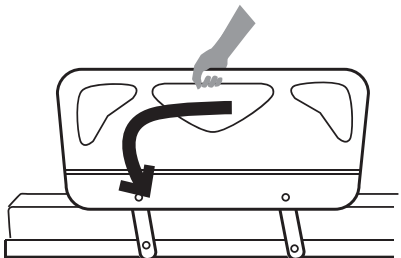

Lower bedside rail from upper to lower position.

SECTION 4

MAINTENANCE

CLEANING THE BED

The Bed can be cleaned with non-abrasive cleaners.

DETECTING WEAR AND DAMAGE

- Check monthly that all screws are tight and have not loosened.
- Check monthly for cut or exposed wires on the electrical components.
- Inspect monthly for signs of cracking, fraying or any deterioration.
- Contact your equipment provider to replace any defective parts immediately and ensure that the bed is not used until repair job is completed.

LUBRICATING THE BED

A light grease lubricant may be applied to the ball bearing and swivel of the casters every three months.

PERFORMING REGULAR MAINTENANCE

Regular maintenance of bed and accessories is required to ensure proper operation. Casters and axle bolts are also required to be checked for tightness.

The warranty below has been drafted to comply with Federal Law applicable to products manufactured after July 4, 1975. This warranty is extended only to the original purchaser/consumer (or dealer non-consumer who does not buy for resale).

Tuffcare® warrants that its proprietary Institutional Beds will be free from defective workmanship and materials for a period of three (3) years following the date of original manufacture with the following exception: Electronics on the beds are warranted for six (6) months. The warranty period commences on the original manufacture date. If within such warranty period any such product proven to Tuffcare® satisfaction to be defective, such product will be repaired or replaced at Tuffcare® option.

Tuffcare® sole obligation and your exclusive remedy under this warranty shall be limited to such repair and/or replacement. This warranty does not include any labor charges incurred in replacement parts installation. Freight charges to the factory are at the expense of the consumer or seller. Return freight charges will be prepaid by Tuffcare®. For warranty service, please contact the authorized dealer from whom you purchased your Tuffcare® products. In the event that you do not receive satisfactory warranty service, please write directly to Tuffcare®: 4977 La Palma Ave, Anaheim, California, 92807. DO NOT RETURN PRODUCTS WITHOUT PRIOR AUTHORIZATION.

LIMITATIONS AND EXCLUSIONS: The foregoing warranty shall not apply to products subjected to negligence, abuse, misuse, improper operation, improper maintenance, improper storage or damages beyond Tuffcare® control. The evaluation will be solely determined by Tuffcare®. The warranty shall not apply to problems arising from normal wear, or failure to follow instructions, or if parts are not manufactured by Tuffcare®, or do not comply with original equipment specifications that are added to Tuffcare® product.

THE FOREGOING WARRANTY IS EXCLUSIVE AND IN LIEU OF ALL OTHER WARRANTIES, INCLUDING BUT NOT LIMITED TO THE IMPLIED WARRANTIES OF MERCHANTABILITY AND FITNESS FOR A PARTICULAR PURPOSE AND SHALL NOT EXTEND BEYOND THE DURATION OF THE EXPRESS WARRANTY PROVIDED HEREIN. TUFFCARE® SHALL NOT BE LIABLE FOR ANY CONSEQUENTIAL OR INCIDENTAL DAMAGES WHATSOEVER.

This warranty gives you specific rights and you may also have other legal rights which vary from state to state. Some states do not allow the exclusion or limitations of incidental or consequential damage, or limitation on how long an implied warranty lasts, therefore, the above exclusion and limitation may not apply to you.



HIGHER STANDARD FOR HEALTHCARE™

WEST COAST DIVISION

4977 E. La Palma Ave
Anaheim, CA 92807

EAST COAST DIVISION

1290 S. W. 30th Ave
Pomppano Beach, FL 33069

VISIT WWW.TUFFCARE.COM FOR OTHER PRODUCTS

**WHEELCHAIRS • WALKING AIDS • MATTRESSES & SUPPORTS
POWER CHAIRS • SCOOTERS • HOME CARE BEDS • LIFTERS**